

A28

2-stage Capillary and Space Thermostats, IP30 / IP65

Controls are compact with fixed differential per stage and (on most models) adjustable differential between stages. Liquid filled element provides wide range, constant differential over whole range and no influence from barometric pressure.

Since the bulb contains the major portion of the total fill the thermostat may be considered as cross-ambient, capillary and cup temperature variations affect the operating point only slightly due to the small amount of fill they contain.

For quantity orders it is possible to have the below stated optional constructions:

- Without case and cover for panel mounting
- Close differential per stage
- Different capillary lengths

All standard IP30 enclosure models have a universal way of adjustment. For this purpose a knob and sealing cap are enclosed.

Features

- Liquid filled sensing element
- Dust tight Penn switch
- IP65 protection class models available
- Front adjustment

Application

These thermostats are designed for various types of heating, cooling, ventilation, or air-conditioning applications. All models have two SPDT switches providing the following control possibilities:

- 2 stage heating
- 2 stage cooling
- Heating/cooling with automatic changeover



IP30



IP65

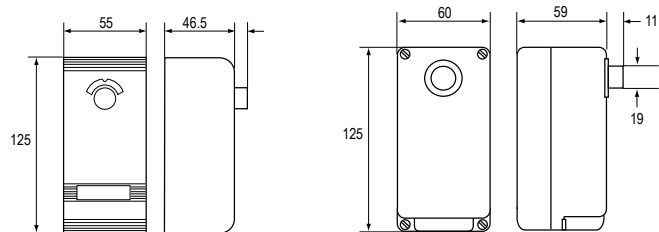

Dimensions in mm

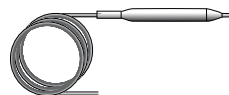

Style 1b

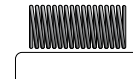

Style 3

REFRIGERATION COMPONENTS

Temperature Controls

272

A28

Two-stage Capillary and Space Thermostats, IP30 / IP65

Ordering Codes	Range (°C)	Diff. (K)		Style	Cap. Length (m)	Bulb Size (mm)	Switch 5A Auto Recycle	Additional Features NEMA 1 Enclosure
		stage	betw					
A28 Capillary and Space Thermostats, IP30								
A28AA-9006	-35 to +10	2	1 to 4	1b	2	110	SPDT Open Low	General purpose
A28AA-9007	-5 to +28	1.5			5	135		
A28AA-9106								
A28AA-9113	0 to 43			3	---	---	SPDT Open High	Bulb stainless steel, General purpose
A28AA-9118	1 to 60	2		1b	3	115		Max. bulb temp. 85 °C, General purpose
A28 Capillary and Space Thermostats, IP65								
A28QA-9101	5 to 50	2	4	1b	2	110	SPDT Open Low	Concealed scale, Screwdriver adjustment
A28QA-9110	-35 to +10		1 to 4					
A28QA-9111	-5 to +28	1.5			2	135		---
A28QA-9114	-35 to +40	2			3.5	110		---
A28QA-9113	0 to 43	1.5		3	---	---	SPDT Open High	Bulb Stainless Steel
A28QA-9115	1 to 60	2	1b	3	115	---		
A28QA-9117	20 to 40	1.5	3	---	---	Bulb Stainless Steel		
A28QJ-9100	10 to 95		1 to 5	1b	3	100	SPDT Open Low	3 A Switch

Accessories

Accessories for Temperature Controls

Ordering Codes	Description	Primary Usage	Inner Ø x Tube Length Bulb well (mm)	Inside & Outside connector (NPT)	Material Connector Pocket
FTG13A-600R	Closed tank connector Style 1b elements, Max. 10 bar, 120 °C, Min. -40 °C	A19/28/36	---	---	---
KIT012N600	Capillary brackets (6 pieces)	270XT			
WEL003N602R	Bulb well, Max. pressure 70 bar, Temp. 370 °C	---	9.8 x 125	1/2 - 14	Stainless steel
WEL11A601R	Bulb well, Max. pressure 20 bar, Temp. 120 °C, USA item	A19	7.3 x 60	1/2 - 14	Brass/Copper
WEL14A-600R	Bulb well, Max. pressure 69 bar, Temp. 370 °C, USA item	A19/28/36	11.2 x 120	1/2 - 14	Monel/Monel
WEL14A602R	Bulb well, Max. pressure 20 bar, Temp. 120 °C, USA item	A19/28/36	9.8 x 125	1/2 - 14	Brass/Copper
WEL14A603R	Bulb well, Max. pressure 20 bar, Temp. 120 °C, USA item	A19/28/36	9.8 x 147	1/2 - 14	Brass/Copper
WEL16A-601R	Bulb well, Max. pressure 20 bar, Temp. 120 °C, USA item	A19/28/36	9.5 x 71	1/2 - 14	Brass/Copper